

# HOW TO USE

1. Remove label from dispenser before using.

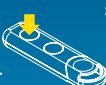

2. In an emergency, press button firmly to dispense tablet.



3. Chew and swallow the tablet immediately as directed by a doctor.

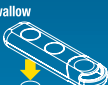

## RETAIN CARD FOR COMPLETE PRODUCT WARNINGS AND INFORMATION

### Drug Facts

#### Active Ingredient (in each tablet) Purposes

Aspirin 325 mg (NSAID)\*.....pain reliever/fever reducer  
\*nonsteroidal anti-inflammatory drug

**Uses** provides temporary relief of ■ headache  
■ pain and fever of colds muscle pain ■ menstrual pain  
■ toothache ■ minor pain of arthritis

**Warnings** **Reye's syndrome:** Children and teenagers who have or are recovering from chicken pox or flu-like symptoms should not use this product. When using this product, if changes in behavior with nausea and vomiting occur, consult a doctor because these symptoms could be an early sign of Reye's syndrome, a rare but serious illness.

**Allergy alert:** Aspirin may cause a severe allergic reaction which may include: ■ hives ■ facial swelling  
■ asthma (wheezing) ■ shock

**Stomach bleeding warning:** This product contains an NSAID, which may cause severe stomach bleeding. The chance is higher if you: ■ are age 60 or older ■ have had stomach ulcers or bleeding problems ■ take a blood thinning (anticoagulant) or steroid drug ■ take other drugs containing prescription or nonprescription NSAIDs (aspirin, ibuprofen, naproxen, or others) ■ take more or for a longer time than directed ■ have 3 or more alcoholic drinks everyday while using this product

**Do not use** if you are allergic to aspirin or any other pain reliever/fever reducer.

**Ask a doctor before use if** ■ the stomach bleeding warning applies to you ■ you have a history of stomach problems, such as heartburn ■ you have liver cirrhosis ■ you have asthma ■ you have high blood pressure ■ you have heart or kidney disease ■ you have taken a diuretic

**Ask a doctor or pharmacist before use if you are**  
■ taking any other drug containing an NSAID (prescription or nonprescription) ■ taking a blood thinning (anticoagulant) or steroid drug ■ taking a prescription drug for diabetes, gout or arthritis

### Drug Facts (continued)

#### Stop use and ask a doctor if

- you experience any of the following signs of stomach bleeding: • feel faint • vomit blood • have bloody or black stools • have stomach pain that does not get better
- an allergic reaction occurs. Seek medical help right away.
- pain gets worse or lasts more than 10 days
- redness or swelling is present ■ fever gets worse or lasts more than 3 days ■ any new symptoms occur
- ringing in the ears or loss of hearing occurs

**If pregnant or breast-feeding,** ask a health professional before use. It is especially important not to use aspirin during the last 3 months of pregnancy unless definitely directed to do so by a doctor because it may cause problems in the unborn child or complications during delivery.

**Keep out of reach of children.** In case of overdose, get medical help or contact a Poison Control Center right away.

**Directions** drink a full glass of water with each dose

- **adults:** 1 to 2 tablets with water. Dosage may be repeated every 4 hours, not to exceed 12 tablets in 24 hours.
- **children under 12:** consult a doctor

#### Other information

- **TAMPER EVIDENT: DO NOT USE IF THE PLASTIC BLISTER SEAL IS CUT OR BROKEN**
- store at controlled room temperature 15°-30°C (59°-86°F)
- use by expiration date on package

**Inactive ingredients** hypromellose, polyethylene glycol, propylene glycol, starch

#### Questions or comments?

Call toll free at 1-888-206-6037

**At Heart® EMERGENCY ASPIRIN DISPENSER**

Distributed by: Advent Consumer Healthcare  
Cedar Grove, NJ 07009 www.at-heart.com

© 2009 U.S. Patent Nos. 7,252,208 and 507,965